

INTERCHANGEABLE CYLINDER & KEY

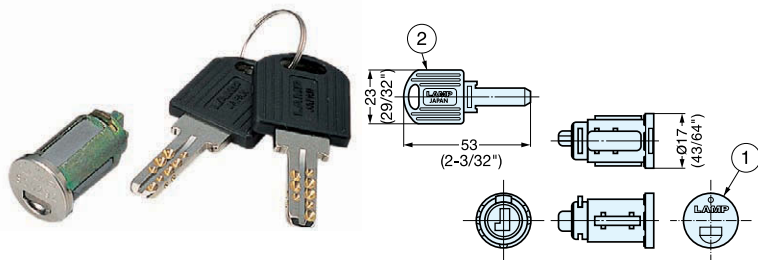

MD-N1



- Cylinder and key set for 1830, 6830 and 1330GL locks.
- Interchangeable feature allows easy cylinder replacement in case key is lost.
- Up to 6,500 key changes available. (750 key changes per master key.)
- Keyed Alike (KA) or Keyed Different (KD) available. Please specify when ordering.

Item No.	No.	Weight (g)	Box (pcs)	Carton (pcs)	No.	Part Name	Material	Finish
MD-N1	①	21	12	60	①	Interchangeable Cylinder	304 Stainless Steel/Zinc Alloy	Polished/Yellow Zinc Chromate
	②	12			②	Key	Brass/ABS	Nickel/Black

INTERCHANGEABLE CYLINDER KEY



MD-MK1, K1



- MD-MK1 - Master key for easy key management.
- MD-K1 - Change key to replace cylinder.

Item No.	Key Type	Weight (g)	Box (pcs)	Carton (pcs)	Material	Finish/Color
MD-MK1	Master Key	12	1	10	Brass/ABS	Nickel/Black
MD-K1	Change Key					

GLASS DOOR LOCK



1330GL-MK



- Interchangeable Cylinder Lock (Please see page P.537 for details.)
- Cylinder can be changed by using change key MD-K1.
- Easy to replace cylinder in case key is lost. *Cylinder case only. Interchangeable Cylinder MD-N1 must be ordered for a complete assembly.

1330GL-MK/GA

1330GL-MK/DN

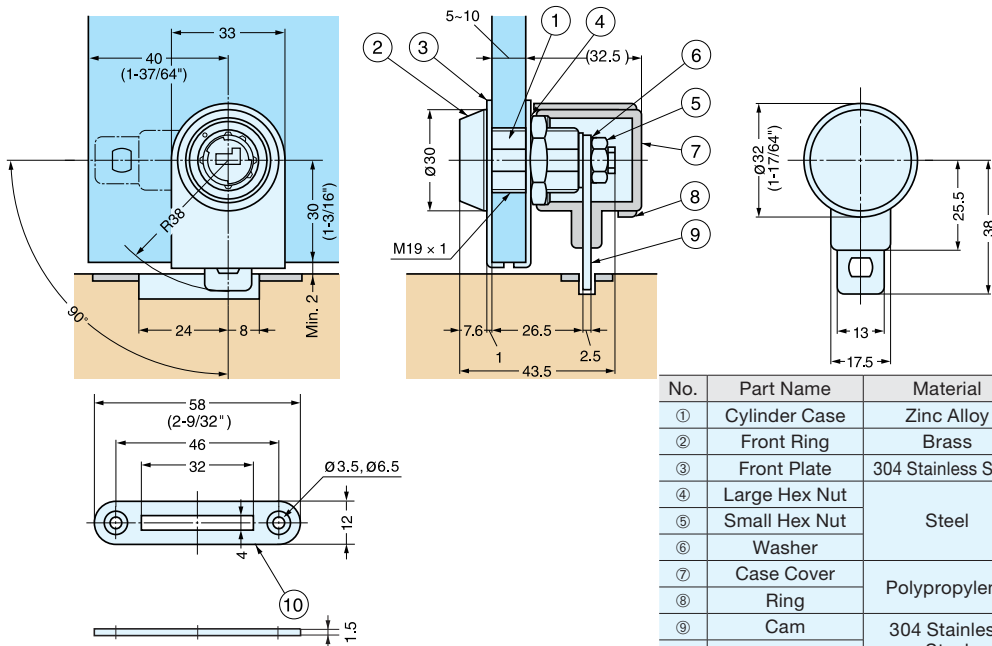

Master Key, Interchangeable Cylinder, Interchangeable Cylinder Key are sold separately.

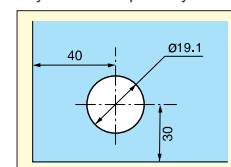

Cut Out Dimensions

No.	Part Name	Material	Finish
①	Cylinder Case	Zinc Alloy	Barrel Polished/Zinc Chromate
②	Front Ring	Brass	Satin Nickel (DN)/Gold (GA)
③	Front Plate	304 Stainless Steel	Polished/Gold (GA)
④	Large Hex Nut	Steel	Yellow Zinc Chromate
⑤	Small Hex Nut		
⑥	Washer	Polypropylene	Black
⑦	Case Cover		
⑧	Ring	304 Stainless Steel	Barrel Polished
⑨	Cam		
⑩	Counterplate		Polished

Item No.	Glass Thickness	Finish	Weight (g)	Box (pcs)	Carton (pcs)
1330GL-MK/GA	5-10	Gold (GA)/Clear	130	12	60
1330GL-MK/DN	5-10	Satin Nickel (DN)			