

BUTT HINGE

Meets **ANSI** SPECS.

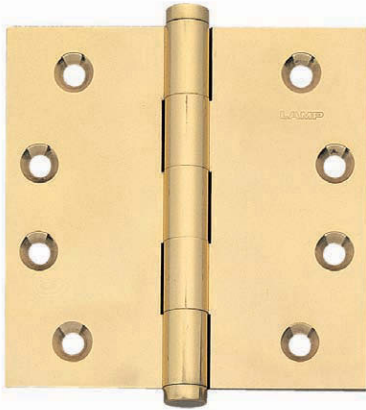

3535, 4040



4040 / PB

- Door Size: Max. W800 x H2000 (W 31-1/2" x H 78-3/4")
- Door Weight: Max. 20kg/pair (44 lbs/pair)

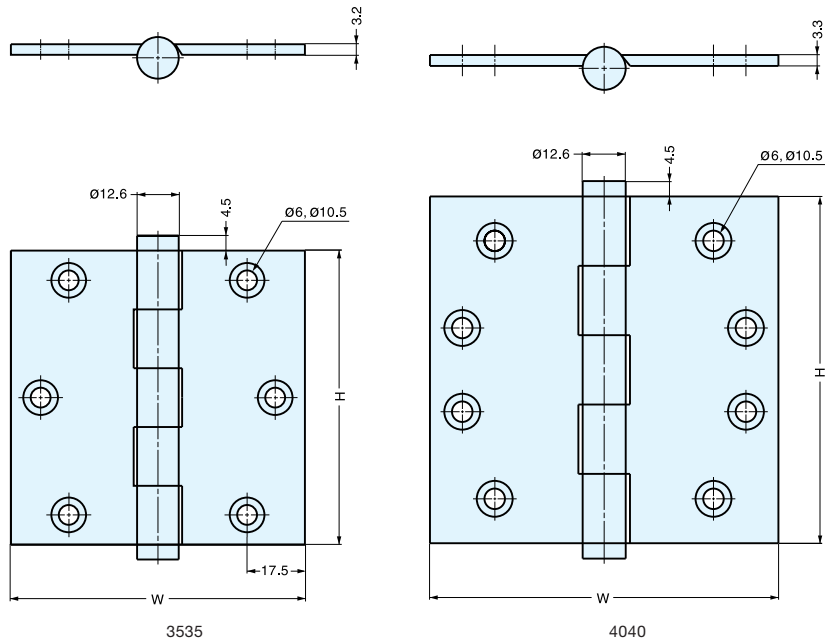

Item No.		H	W	Weight (g)	Box (pcs)	Carton (pcs)	Material	Finish
3535 / PB	3535 / CR	89 (3-1/2")	89 (3-1/2")	265	2	60	Brass	Polished Brass (PB) Chrome (CR)
4040 / PB	4040 / CR	101.5 (4")	102 (4-1/64")	345		40		

BUTT HINGE (W/BALL BEARING)



4040B

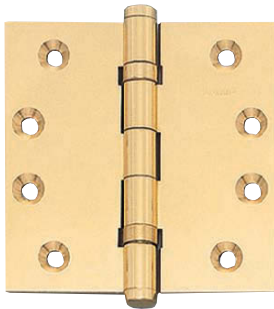

4040B PB

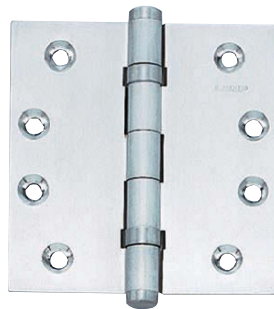

4040B SC

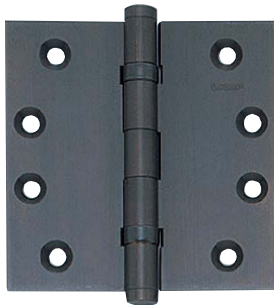

4040B AB

- Smooth function with ball bearing.
- Door Size : Max. W900 x H2000.
- Door Weight : 50 kg/pair.

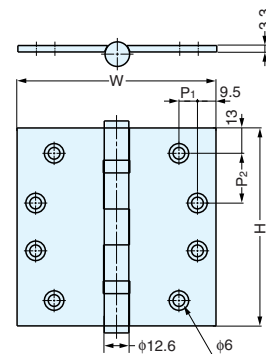

Material	Finish
Brass	Polished Brass (PB)
	Satin Chrome (SC)
	Antique Brass (AB)

Item No.			H	W	P1	P2	Weight (g)	Box (pcs)	Carton (pcs)
4040B PB	4040B SC	4040B AB	101.5	102	9.5	25.5	330	2	40